

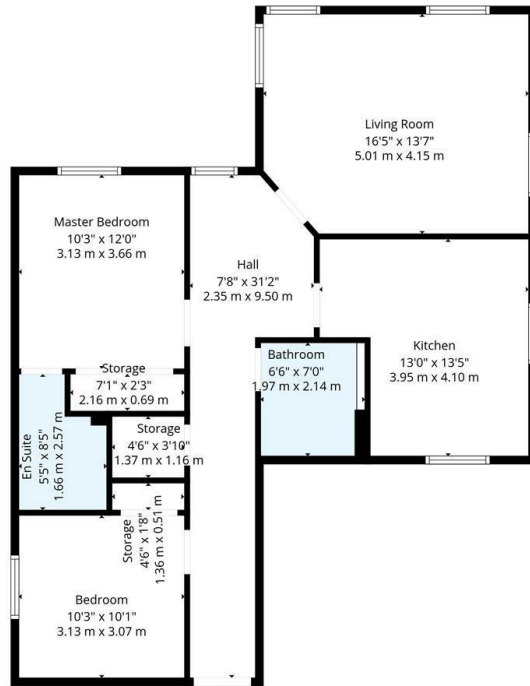

Flat 8, 3 Lowland Court, Glasgow, G33 6FF

Offers Over £180,000

- Larger Style Penthouse Apartment with corner position
- Modern Kitchen Diner
- Residents parking
- EER Band C
- Two double bedrooms with built in wardrobes
- En-Suite Shower room off master bedroom plus separate main bathroom
- Security entry, GCH and DG
- Spacious Lounge with dual aspects
- Stylishly presented throughout
- Short walk to train station and Bannatyne's gym



TOTAL: 872 sq. ft, 81 m²
 1st floor: 872 sq. ft, 81 m²
 EXCLUDED AREAS: STORAGE: 44 sq. ft, 5 m², WALLS: 74 sq. ft, 7 m²
 Floor Plan Created By Cubicasa App. Measurements Deemed Highly Reliable But Not Guaranteed.

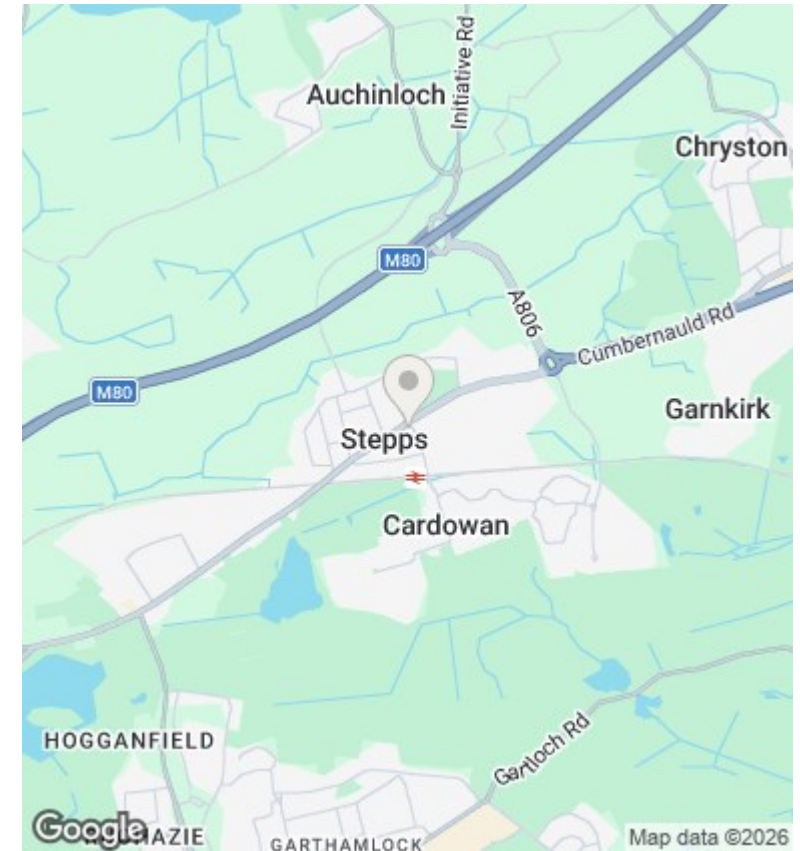

Directions

Viewings

Viewings by arrangement only. Call 01417262111 to make an appointment.

Council Tax Band

EPC Rating:

C

Energy Efficiency Rating		
	Current	Potential
Very energy efficient - lower running costs		
(92-plus) A		
(81-91) B		
(69-80) C	80	80
(55-68) D		
(39-54) E		
(21-38) F		
(1-20) G		
Not energy efficient - higher running costs		
Scotland	EU Directive 2002/91/EC	